

结构特点 Design features

- 内装、单端面、波形弹簧、平衡型、传动套传动结构，任意旋向，结构紧凑，安装方便。
 - 安装尺寸符合ISO3069、DIN24960和GB6556标准。
 - 橡胶O形圈结构，推进型密封；
 - 外形尺寸及安装尺寸与58B和59B相同，成套密封可互换。
 - 静环可配G9、BP和BO等形式。
-
- Internally mounted, single face, With Super-Sinus spring, balanced structure and driven by brace ear and claw transmission, compact construction, any rotation direction it can be mounted conveniently.
 - Conform to the standard of DIN24960, ISO3069 and GB6556.
 - O-ring pusher type seal.
 - The shape and installation size is identical to 58U and 59U.
 - Style"G9","BP","BO" seat ring can be used as mating ring of this rotary unit.

材料 Materials(to DIN24960)

- 旋转环 Rotary Ring: A、Q1、Q2、V1
- 静止环 Stationary Ring: A、B、Q1、Q2
- 辅助密封 Auxiliary Seal: P、E、V、M1
- 弹簧及其他结构件材料 Spring and Other Parts: F、G



适用范围 Operating limits

- 压力 Pressure: $\leq 2.5\text{MPa}$
- 温度 Temperature: $-40\sim 200^\circ\text{C}$
- 线速度 Speeds: $\leq 20\text{m/sec}$
- 粘度 Viscosity: $\leq 1.0\text{Pa.s}(1000\text{cp})$ 软对硬(Soft VS Hard)
 $\leq 3.5\text{Pa.s}(3500\text{cp})$ 硬对硬(Hard VS Hard)

用途 Applications

用于化工、石油化工、炼油、制冷、制药、造纸、给排水、污水处理等工业的泵类、反应釜、压缩机等类似的旋转轴密封。Used in all types of rotating equipment, pumps, mixers, agitators and compressors. to suit industries such as general chemical, oil refining, petrochemical, pharmaceutical, food processing, pulp and paper, and waste water treatment.

介质 Medium

油类、水、盐、非结晶性溶剂、有机溶剂及其它弱腐蚀性溶液。Oil, water, salt, noncrystalline agent, organic solvents and other weak corrosive fluid.

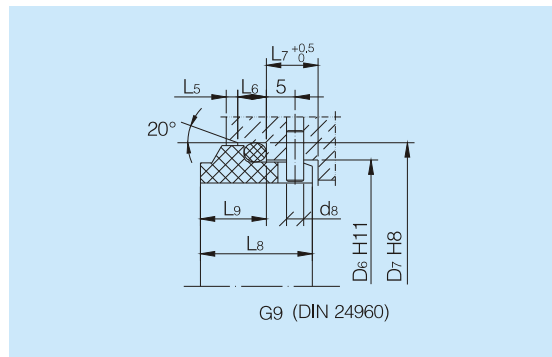
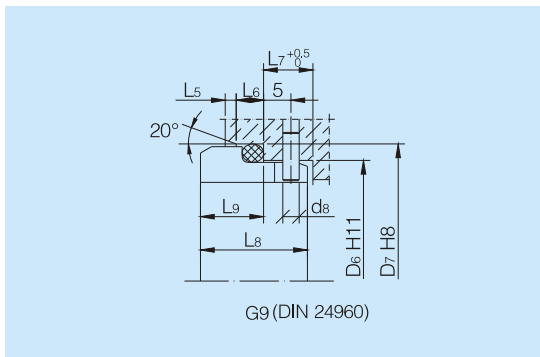
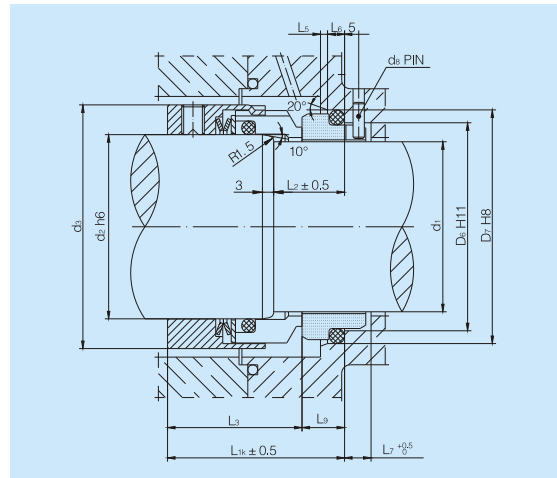

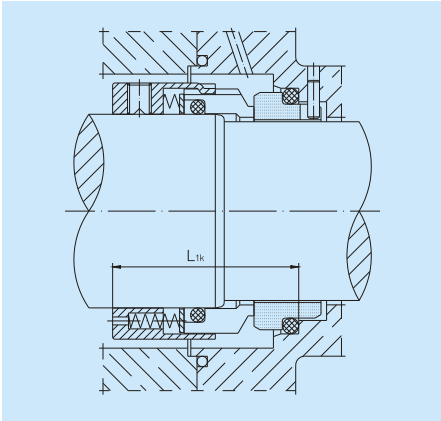

CN H74
 安装尺寸与H7N相同，弹性元件为多弹簧结构
 Dimensions, item no's and descriptions as for H7N,
 but with multiple spring

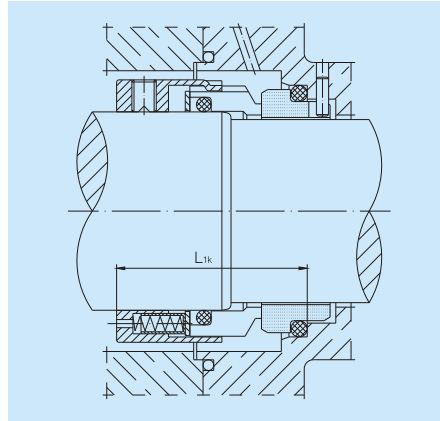

CN H75
 安装尺寸与H7N相同，弹性元件为多弹簧带弹簧
 套结构
 Dimensions, item no's and descriptions as for
 H7N, but with multiple spring (with springhousing)

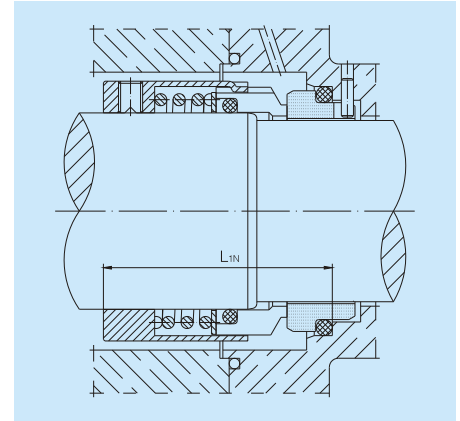

CN H76
 安装尺寸与H7N相同，弹性元件为大弹簧结构，
 适用于轴向窜动量较大的工况。
 Dimensions, item no's and descriptions as for H7N,
 but with single spring for compensating large axial
 movements.

型号Model	d1	d2	d3	D6	D7	d8	L1k	L1N	L2	L3	L5	L6	L7	L8	L9
CN H7N-14	14	18	33	21	25	3	43	—	18	32.5	1.5	4	8.5	17.5	10.0
CN H7N-16	16	20	35	23	27	3	43	—	18	32.5	1.5	4	8.5	17.5	10.0
CN H7N-18	18	22	37	27	33	3	45	55	20	33.5	2.0	5	9.0	19.5	11.5
CN H7N-20	20	24	39	29	35	3	45	60	20	33.5	2.0	5	9.0	19.5	11.5
CN H7N-22	22	26	41	31	37	3	45	60	20	33.5	2.0	5	9.0	19.5	11.5
CN H7N-24	24	28	43	33	39	3	48	60	20	36.0	2.0	5	9.0	19.5	11.5
CN H7N-25	25	30	45	34	40	3	48	60	20	36.0	2.0	5	9.0	19.5	11.5
CN H7N-28	28	33	48	37	43	3	50	65	20	38.5	2.0	5	9.0	19.5	11.5
CN H7N-30	30	35	50	39	45	3	50	65	20	38.5	2.0	5	9.0	19.5	11.5
CN H7N-32	32	38	55	42	48	3	50	65	20	38.5	2.0	5	9.0	19.5	11.5
CN H7N-33	33	38	55	42	48	3	50	65	20	38.5	2.0	5	9.0	19.5	11.5
CN H7N-35	35	40	57	44	50	3	50	65	20	38.5	2.0	5	9.0	19.5	11.5
CN H7N-38	38	43	60	49	56	4	53	75	23	38.5	2.0	6	9.0	22.0	14.0
CN H7N-40	40	45	62	51	58	4	53	75	23	38.5	2.0	6	9.0	22.0	14.0
CN H7N-43	43	48	65	54	61	4	53	75	23	38.5	2.0	6	9.0	22.0	14.0
CN H7N-45	45	50	67	56	63	4	53	75	23	38.5	2.0	6	9.0	22.0	14.0
CN H7N-48	48	53	70	59	66	4	53	85	23	38.5	2.0	6	9.0	22.0	14.0
CN H7N-50	50	55	72	62	70	4	58	85	25	42.5	2.5	6	9.0	23.0	15.0
CN H7N-53	53	58	79	65	73	4	58	85	25	42.5	2.5	6	9.0	23.0	15.0
CN H7N-55	55	60	81	67	75	4	58	85	25	42.5	2.5	6	9.0	23.0	15.0
CN H7N-58	58	63	84	70	78	4	63	85	25	47.5	2.5	6	9.0	23.0	15.0
CN H7N-60	60	65	86	72	80	4	63	95	25	47.5	2.5	6	9.0	23.0	15.0
CN H7N-63	63	68	89	75	83	4	63	95	25	47.5	2.5	6	9.0	23.0	15.0
CN H7N-65	65	70	91	77	85	4	63	95	25	47.5	2.5	6	9.0	23.0	15.0
CN H7N-70	70	75	99	83	92	4	70	95	28	52.0	2.5	7	9.0	26.0	18.0
CN H7N-75	75	80	104	88	97	4	70	105	28	52.0	2.5	7	9.0	26.0	18.0
CN H7N-80	80	85	109	95	105	4	70	105	28	51.8	3.0	7	9.0	26.2	18.2
CN H7N-85	85	90	114	100	110	4	75	105	28	56.8	3.0	7	9.0	26.2	18.2
CN H7N-90	90	95	119	105	115	4	75	105	28	56.8	3.0	7	9.0	26.2	18.2
CN H7N-95	95	100	124	110	120	4	75	105	28	57.8	3.0	7	9.0	25.2	17.2
CN H7N-100	100	105	129	115	125	4	75	105	28	57.8	3.0	7	9.0	25.2	17.2